

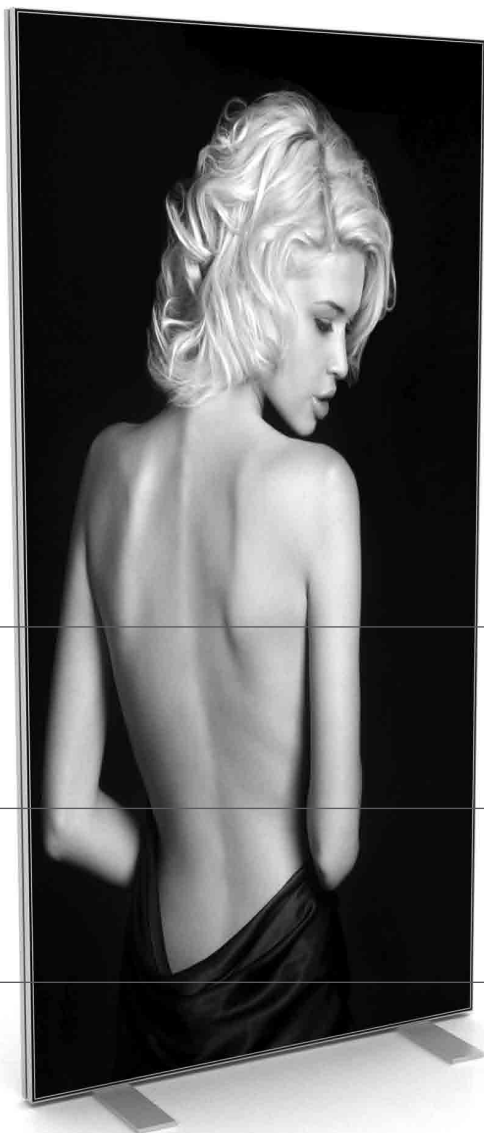

tension fabric system

TFS allows simple fitting and removal of tension fabric graphics. Frames are simple to assemble using just one tool.



//tension fabric system

portable

easy assembly

expandable

Range of freestanding flat display panels in various standard sizes or bespoke. Integral system channel allows easy attachment of accessories

Freestanding double sided frame with slimline rectangular feet or optional side mounted feet.





Curved 2x2 metre double sided frame.

//tension fabric system

showrooms
exhibitions
reception and foyer areas
roadshow events
museum graphics
interiors

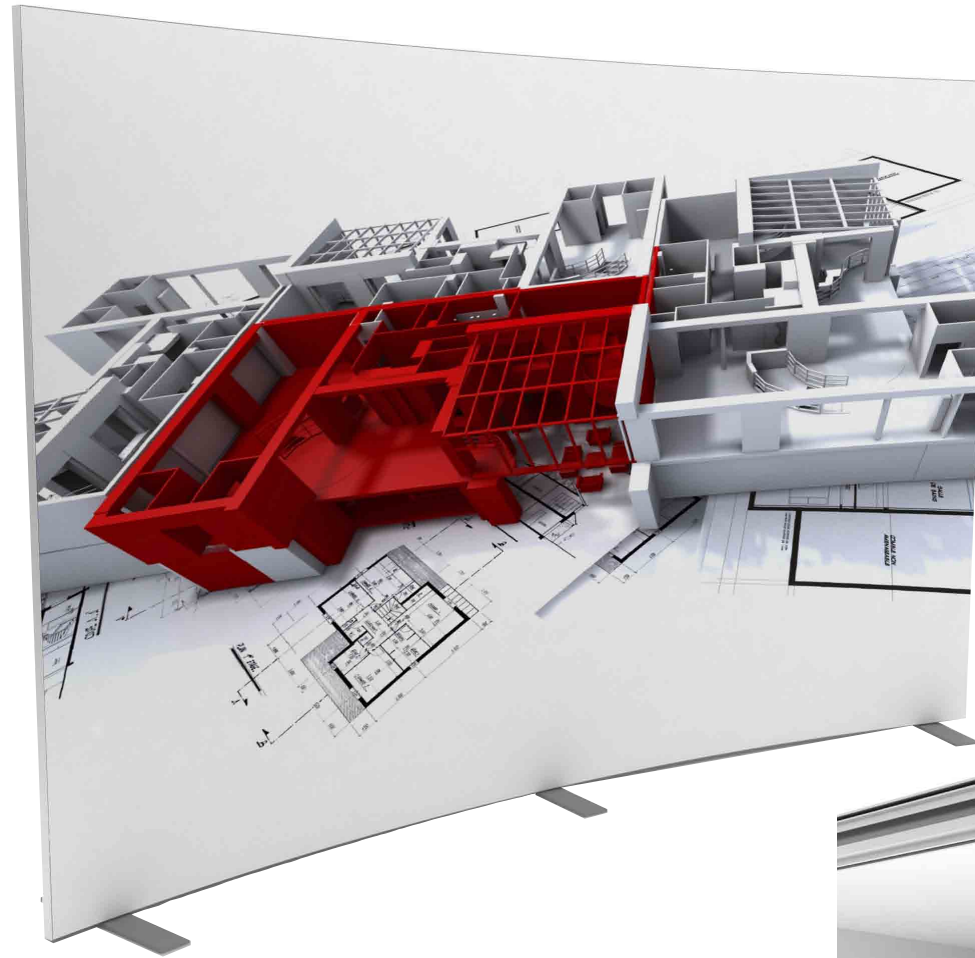

Range of freestanding curved display panels in various standard sizes or bespoke.



Integral system channel allows easy attachment of accessories

//tension fabric system

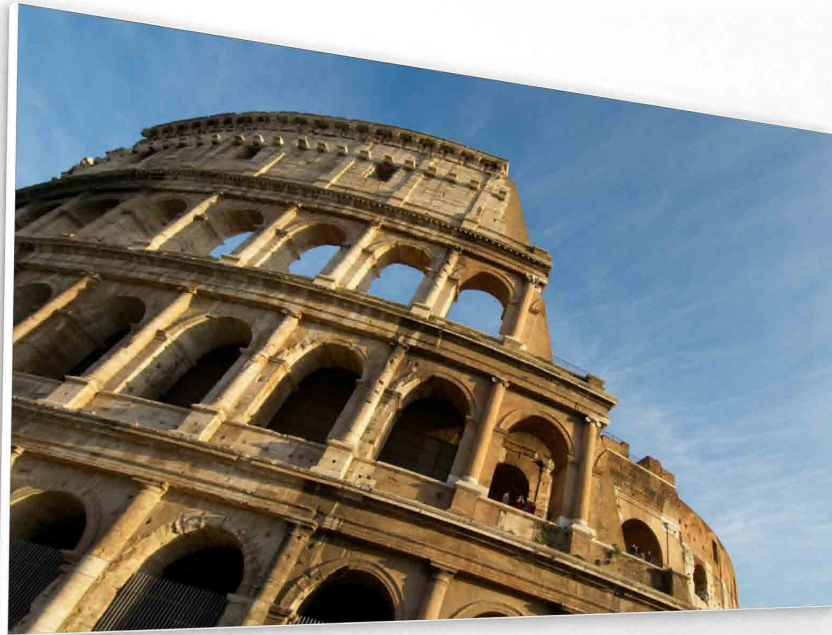

Brackets UA10173 screw fixed to wall. Frame hooks onto brackets. Brackets supplied with kit.

//wall mounted tfs

portable

easy assembly

expandable

Range of flat display panels in various standard sizes or bespoke.
Utilising large single sided TFS Profile UA10169



Available as flat or curved frames. Spans unsupported between wall mount brackets

Wall mosaic utilising single sided slimline profile UA11437



//tension fabric system

showrooms

exhibitions

reception and foyer areas

roadshow events

museum graphics

interiors

portable

easy assembly

expandable

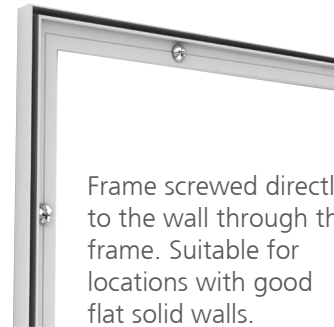

//tension fabric system

Range of slimline flat display panels in various standard sizes or bespoke up to 3.0m H. x 50m W. Wall mounted by screwing directly through the frame into solid wall at regular intervals.

portable

easy assembly

expandable



//LED Lightbox in TFS system

A lightweight display lightbox featuring easy to change printed fabric graphics, utilising cutting edge LED lighting technology. Gives an even spread of light with no hotspots. Highly energy efficient with an expected lamp life in excess of 30,000 hours resulting in a hassle free product with low maintenance and running cost.

- Even spread of light with no hotspots.
- Highly energy efficient.
- Seamless graphics up to 3.5m high x 50m wide.

portable

easy assembly

expandable

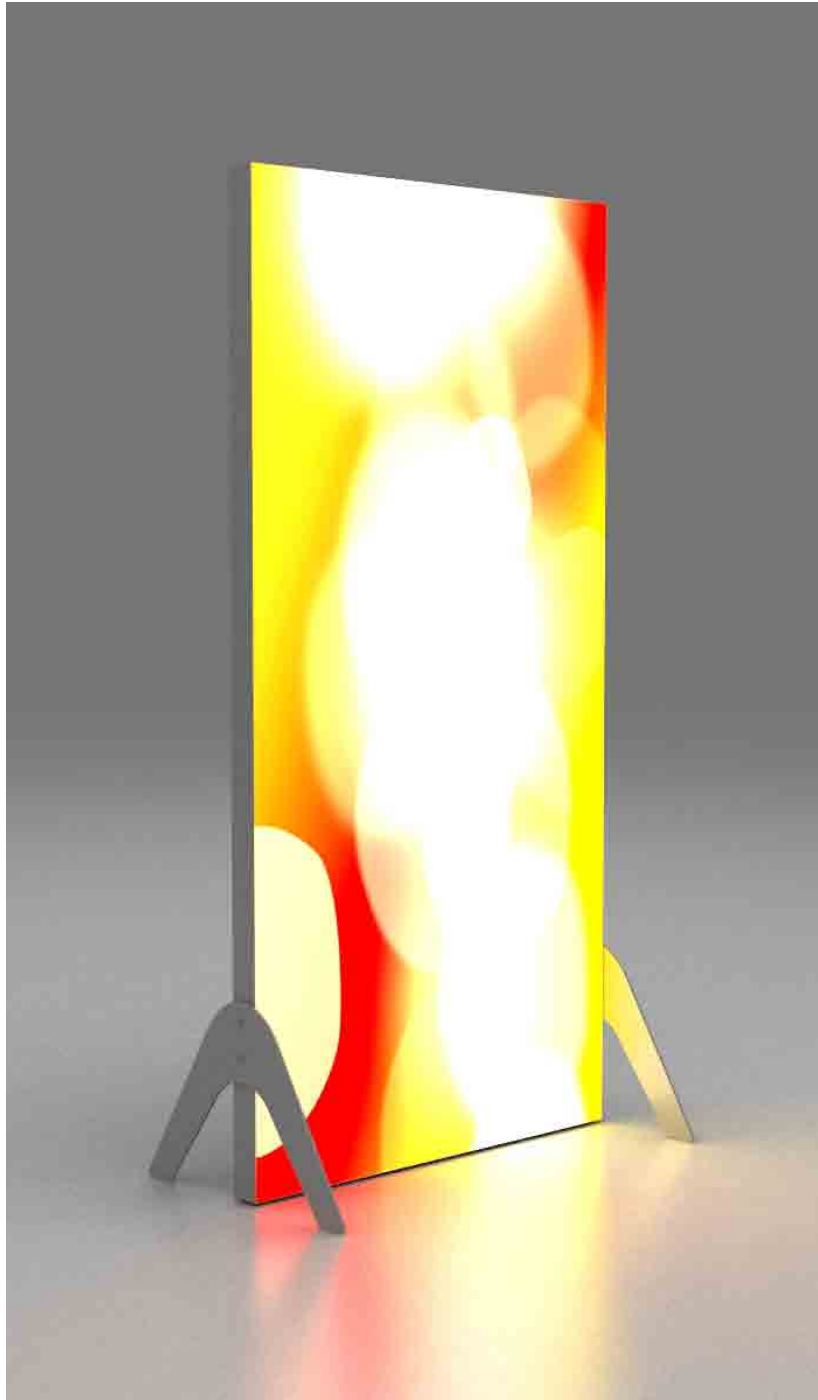

//features and benefits

Features

Slimline frame profile.

High quality LED technology with an expected lamp life in excess of 30,000 hours.

Easy to insert PVC edge strip.

Even light distribution with no hot spots or shadow.

Energy efficient.

New Side Profile foot

Benefits

Frameless graphic for maximum impact.

Zero maintenance and only 36W power per square metre.

Quick and easily changeable graphic.

Upto 3.5m high x 50m width.

Low carbon footprint.

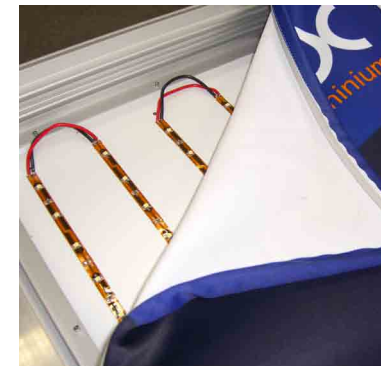
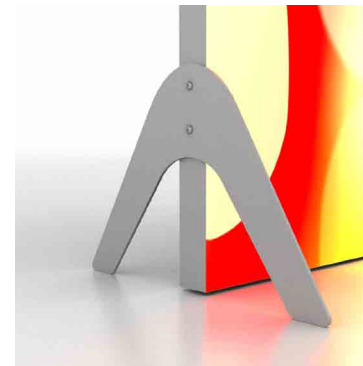

Freestanding privacy pods in various standard sizes or bespoke. Lightweight and easy to assemble. Ideal for use as breakout area, consultation booth or meeting area. Can be used as permanent or temporary structures.

//TFS Pod



tension fabric system

portable

easy assembly

expandable



Lightweight & Easy to assemble

Can be used as a temporary or permanent structure

Custom TFS Graphics printed on both inside and outside of POD

All openings based on 270° Arc

showrooms

exhibitions

reception and foyer areas

portable

roadshow events

easy assembly

breakout areas

expandable

interiors



//Double Sided Archway Curves

Range of freestanding archway curves in various standard sizes or bespoke.

Lightweight and easy to assemble.

Ideal for use as decorative or feature displays.





Standard Archway heights of 2.4m or bespoke sizes.



portable

easy assembly

expandable

TFS Archways are perfect for attracting attention & promotion at exhibitions, with double sided bespoke graphics and modular accessories

//Vertical Curved TFS

Freestanding double sided frame with feature side mounted feet. Curved, but a bit different. Stand out from the crowd!

Made in various standard sizes or bespoke upto 3.0m H. x 50m W. Integral system channel allows easy attachment of accessories.

tension fabric system

portable

easy assembly

expandable

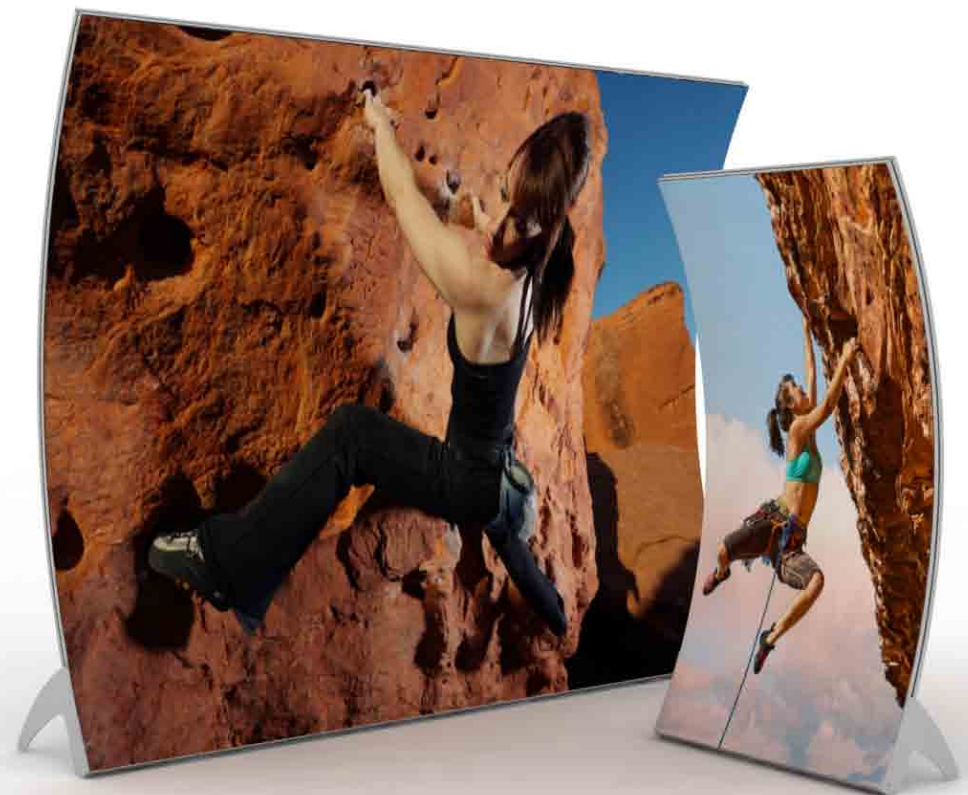

portable

easy assembly

expandable



Vertical Freestanding TFS AV Stand, with bespoke double sided graphics and brackets capable of holding an LCD Screen of up to 32".

Freestanding range of special Tension Fabric System stands

//specials



Freestanding TFS with feature curved top.

Modular exhibition stands and display systems offer great quality and huge versatility. They are one of the UK's most user-friendly and cost-effective modular, exhibition stand and graphic display systems, and offer designers the freedom to create innovative stand designs

//exhibition



tension fabric system

portable

easy assembly

expandable



creative freedom. versatile configurations

Example of effective use of TFS in conjunction with traditional build exhibition stand



The addition of TFS into the exhibition system further expands the possibilities of creative & cost effective stand designs



Freestanding Tension Fabric System Backwall

//accessories

- Literature holders
- Poseur table kit
- Spotlights
- Workstation counter kit
- 2 alternative feet
- Carry cases

//acrylic colour choice

select from a choice of six standard colours.



A4 acrylic literature holder. Can be either front or side mounted. Available colour options shown above.



Poseur table kit. Tops available in six standard colours.

//go configure

//customise your display



A4 steel literature holder. Can be either front or side mounted.



2 carry bags available.

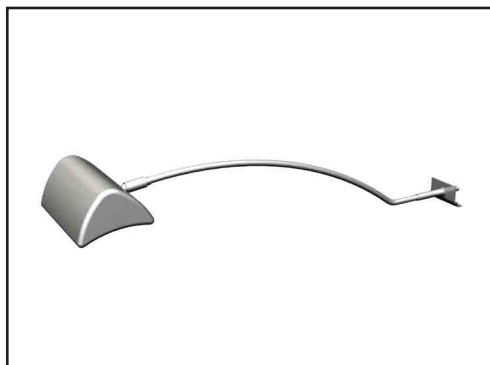

240V 150W linear halogen.

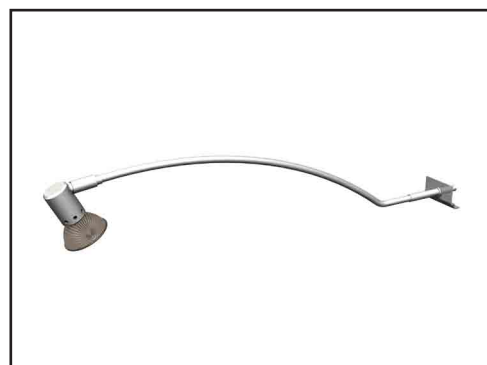

12V 50W capsule swan neck.



UA9876 Folding portable counter kit. Can be assembled in 5 minutes and fits into UA6406 carry case, shown inset. Includes top. Acrylic panels to match other accessories available to special order.

//profiles and connectors

 <p>W 31.5 mm H 43.25 mm 4.25 mm 8.5 mm</p>	 <p>W 46.5 mm H 50 mm 4.25 mm 8.5 mm</p>	 <p>W 16.5 mm H 35 mm 8.5 mm</p>	 <p>W 26 mm H 35 mm 8.5 mm</p>	 <p>W 17.5 mm H 23.6 mm 4.25 mm</p>	 <p>W 66.5 mm H 24.8 mm 4.25 mm</p>
<p>UA 10169 Single sided banner frame profile</p>	<p>UA 9544 Double sided banner frame profile</p>	<p>UA 2667 Support beam profile</p>	<p>UA 4696 Support beam profile</p>	<p>UA 11437 Single sided micro banner frame profile</p>	<p>UA 10584 Lightbox profile</p>
					
<p>UA 10775 90 ° Corner connector</p>	<p>UA 4398 90 ° Corner connector</p>	<p>UA 11964 Extension bar/ 180° connector for micro TFS profiles</p>	<p>UA 3832 Extension bar/ 180° connector</p>	<p>UA 12592 TFS Inline Connector</p>	<p>UA 10189 Rectangular base plate 445 x 76 x 10mm. UA4794 245 x 76 x 10mm Finish powder coat silver sparkle</p>

//connectors and accessories

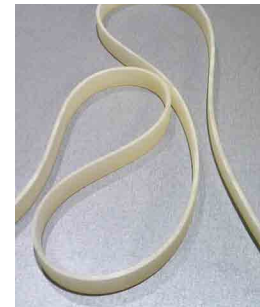
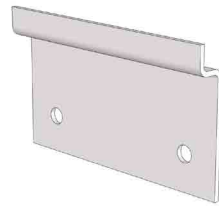
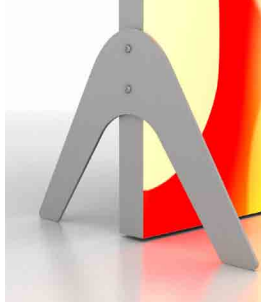

UA 12296
Offset side mount foot. Silver. Suits vertical curved frames and archways only

UA 10469
Side mounted foot

UA 10173
Wall mounted bracket

UA 7585
Eye bolt and roll nut set

UA 10182
Silicone strip (100M roll) 3mm thick x 15mm W.

UA 3997
Swan neck lamp 240V 150W

UA 3998
Swan neck lamp 12 volt 50W



UA 4809
Daisy chain connector for swan neck light power leads

UA 6272
3mm Allen key
UA 6273
4mm Allen key
UA 6274
5mm Allen key

UA 4807
Carry case with castors

UA 6406
Fabric carry case

UA 4370
A4 acrylic literature holder available LH/RH and front fixed

UA 10420
Poseur table kit

UA 9876
Folding portable counter kit

//single sided frames

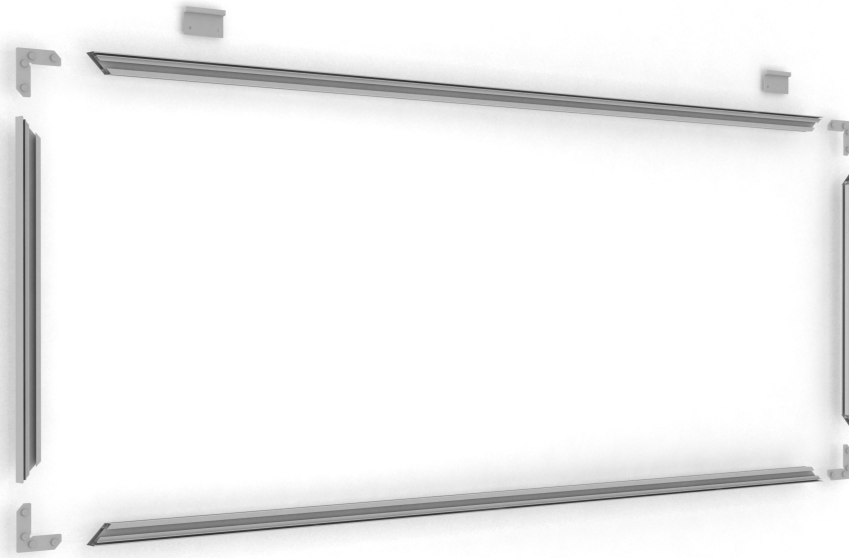

UA10169 single sided profile utilises UA10775 corner brackets and is fixed to wall with UA10173 brackets.

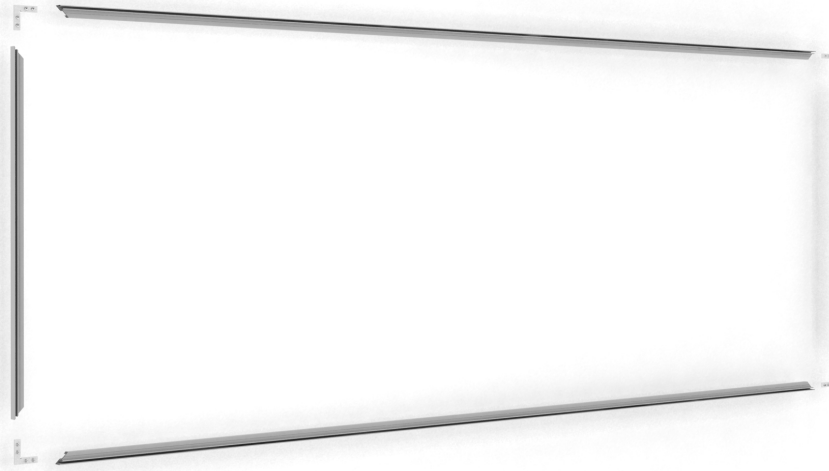

UA11437 micro single sided profile utilises UA4398 corner brackets.
Micro frames fix directly to the wall through the frame.

1. Connect aluminium frame together using corner brackets UA10775 [1 per corner for single sided].
2. Fabric has silicone strips sewed into edge which is pushed into facing channel on aluminium frame.
3. Screw brackets into wall.
4. Hang frame over bracket flange at an angle and then flatten once located in channel.



//double sided frame

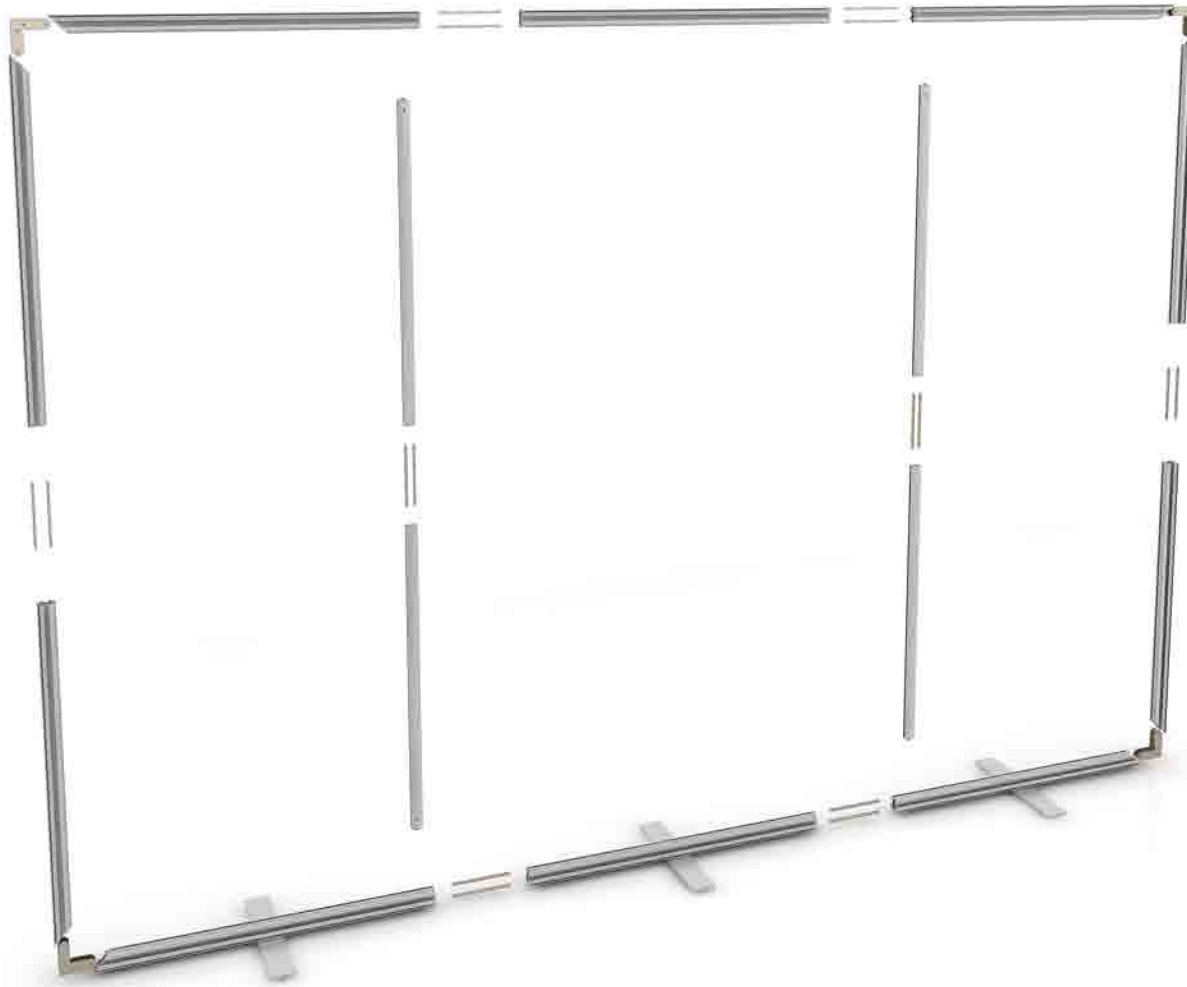

Intermediate support bars required on sizes 2m and over.
Extension bars required for knock-down kits only.
Example shown is 3.5 x 2m.

1. Connect aluminium frame together using corner brackets UA10775 [works with 1 but 2 brackets per corner are recommended to give a neatly aligned and robust mitre].

2. Fabric has silicone strips sewed into edge which is pushed into facing channel on aluminium frame.

3. Screw feet into frame using M8 countersunk screws into roll nuts.



//fabric insertion

Step 1

Insert the fabric by pushing the silicone strip into the channel of the extrusion. The fabric has a tab to allow for easy extraction.

Step 2

Once all the silicone strip has been placed into the channels of the extrusion frame, smooth out any wrinkles with your hand.

Step 3

The product is now ready for use.

how it works

//easy to assemble

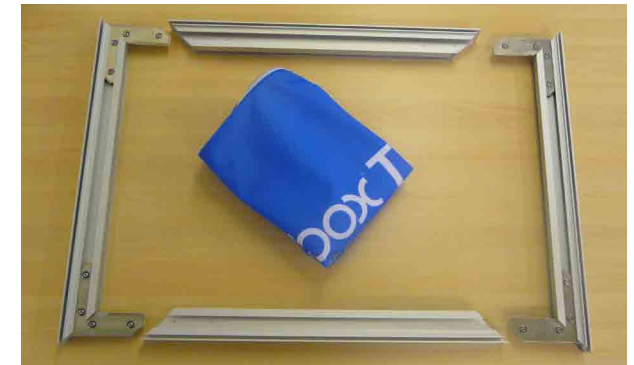

//features and benefits

Features

Flexible modular design.

Graphic support detail keeps fabric in tension.

Graphics can be easily rolled or folded to compact size for convenient transportation.

The product uses over 30% reclaimed and recycled material.



Benefits

Flexible and expandable.

Flat seamless look.

Low logistics cost.

Sustainable and environmentally friendly.

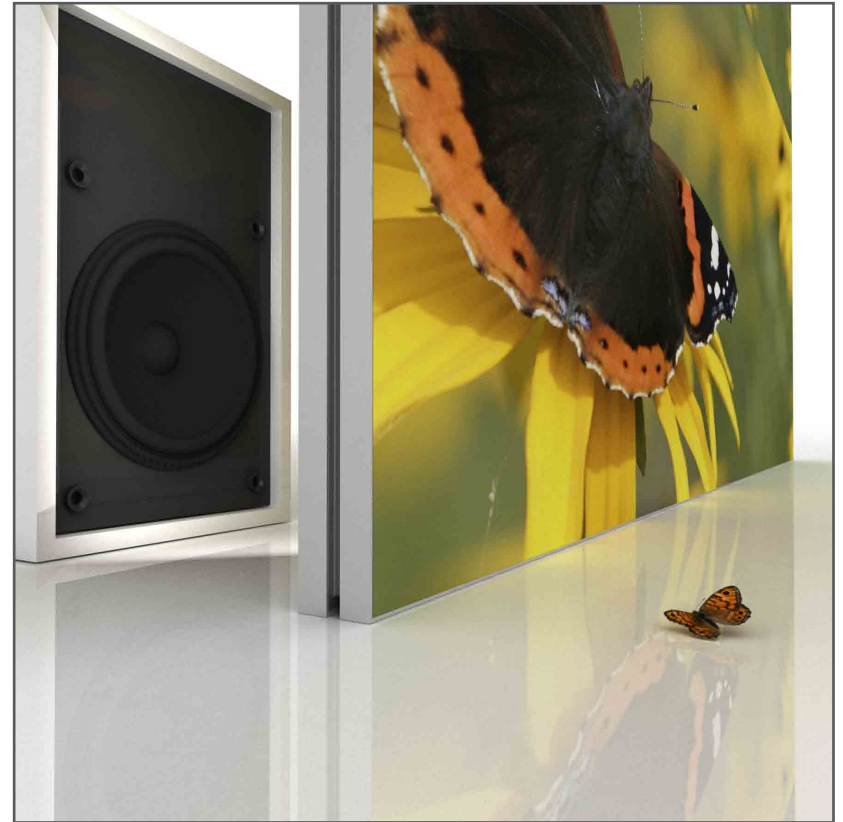

//tension fabric system

TFSBrochure_15G//09/03//11

available from:

//tension fabric system